

Holy Cross Cemetery

Section 23 Holy Family Mausoleum

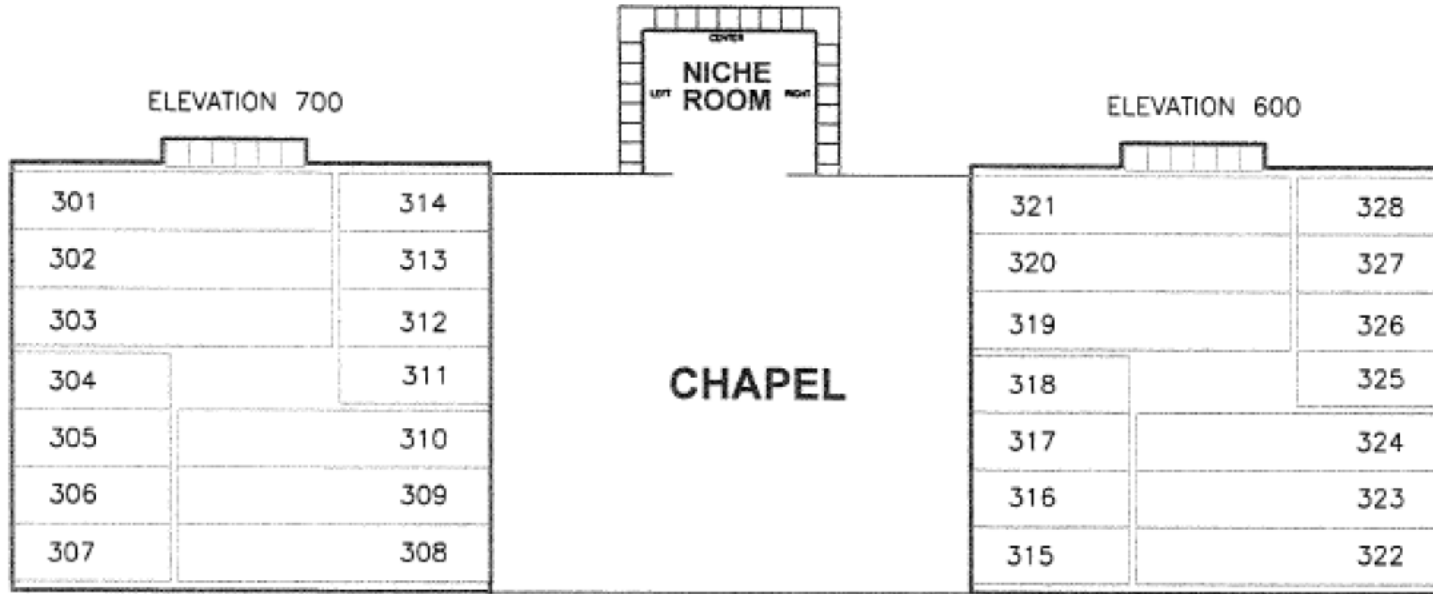

Elevation 500

Elevation 400

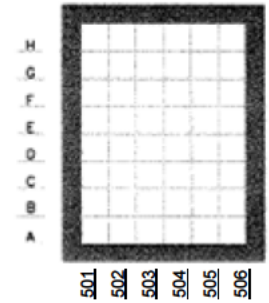
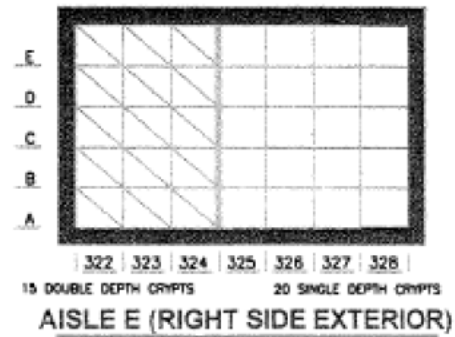
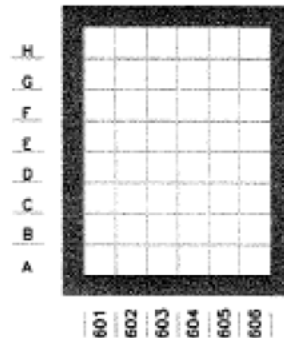
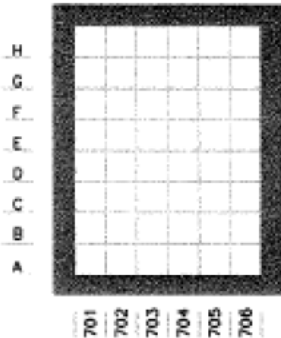
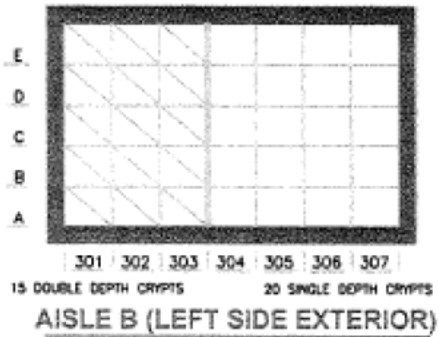

Elevation 500
Front Left

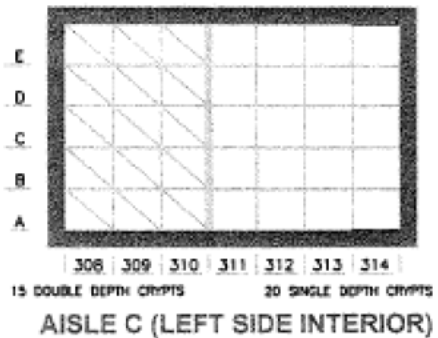

| NICHE SIZES (W x H) | | |
|---------------------|------|--------------|
| ELEVATION | QTY. | SIZE |
| 600, 700 | 96 | 11 x 11 x 11 |

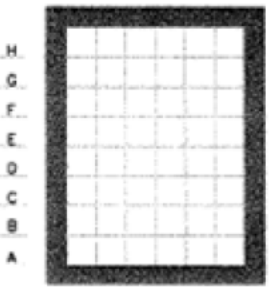
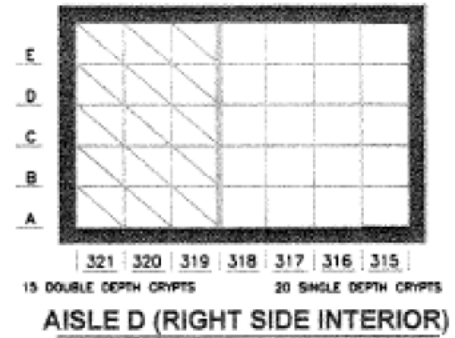

Elevation 400
Front Right

HOLY CROSS CEMETERY, Holy Family Mausoleum INSIDE NICHE

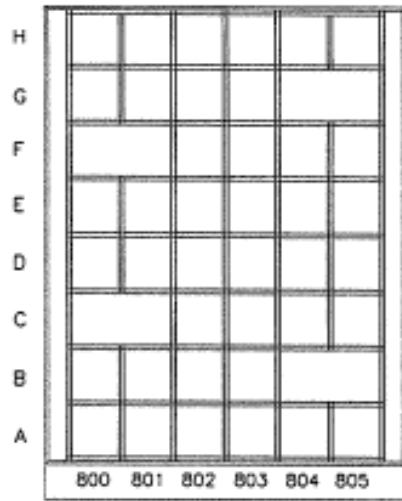

ELEVATION LEFT
48 NICHE

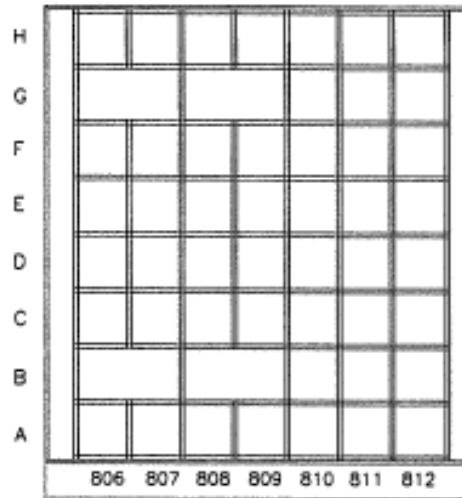

ELEVATION CENTER
56 NICHE

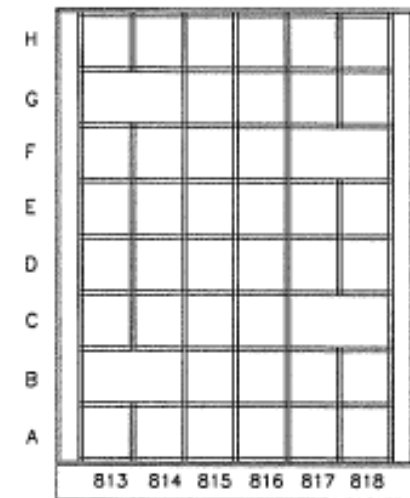

ELEVATION RIGHT
48 NICHE

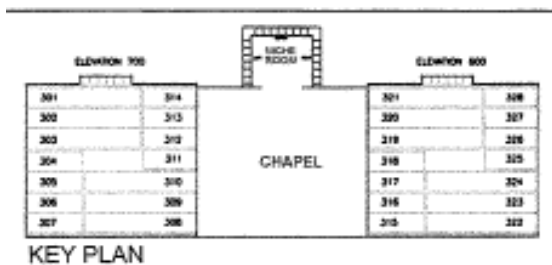
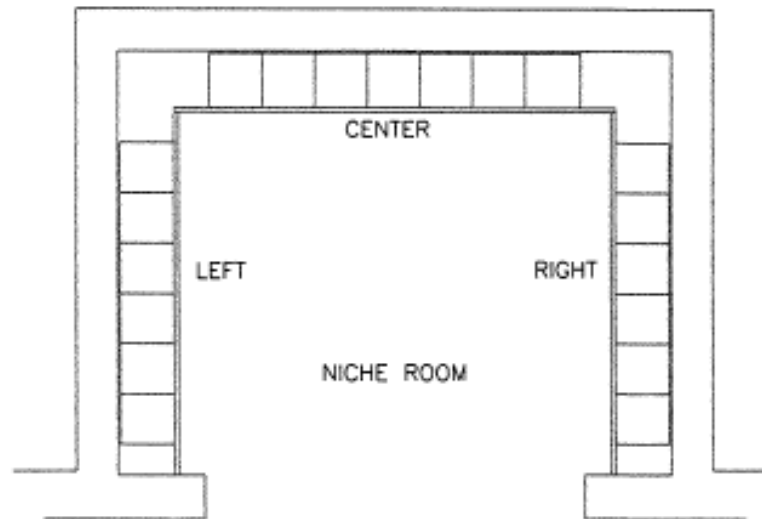

KEY PLAN

NICHE SIZE 11 X 11 X 11